

OPTIMUSS underline 3in1

High Definition Combo Receiver

Thank you for choosing an OPTIMUSS underline 3in1 receiver.

Please consider that this information is effective at the time of printing. You are able to find current information and detailed user manuals at the following website: www.edision.gr

1 To unpack



IR remote with 2 AAA-batteries



documentation

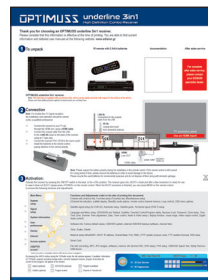

After sales service

For complete after sales service, please contact your EDISION specialist dealer.

OPTIMUSS underline 3in1 receiver

Note: The front face is supplied with a protection film, which can be easily removed, with respect to the surface of the device. Please note that additional parts might be included which are not listed here.

2 Connection

Note: For trouble-free TV signal reception, the installation and calibration should be carried out by a qualified professional.

- Connect the receiver to your TV set through the HDMI port, using a HDMI cable
- Connect the coaxial cable from the LNB, to the «LNB IN» input on the back of the receiver, using an F-type plug
- Connect the receivers PSU 12V/2A to the mains socket.
- Install the batteries in the remote control, paying attention to the correct polarity.

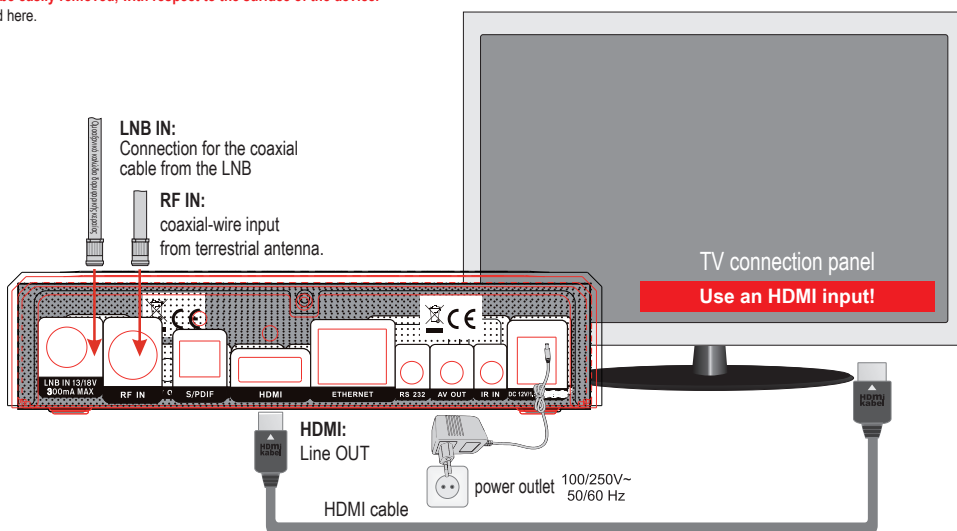
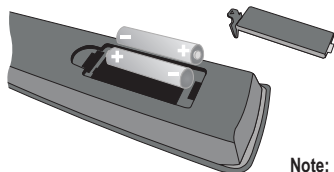

Note: Please respect the battery polarity during the installation in the remote control. If the remote control is left unused for a long period of time, please remove the batteries in order to avoid damage to the device. Please recycle the used batteries for environmental purposes and do not dispose of them along with domestic garbage.

3 Activation:

Activate the receiver by pressing the ON/OFF switch in the back, to the «ON» position. The receiver goes into «BOOT» mode and after a few moments it is ready for use. In case it does not BOOT, please press «POWER» on the remote control. When the BOOT procedure is finished, you can press MENU on the remote control to access the following functions and adjustments:



Main Menu:

System setup

Signal setup

System Information

User preferences

Games

Internet

Access system

USB/PVR access*

Functions and Adjustments (valid on the date of printing this document)

Channel edit (channel list), Favorites setup (Favorites list), Miscellaneous setup (Channel list indication, subtitle display, StandBy mode options, remote control channel memory, Loop control), OSD menu options.

Satellite signal setup (for DVB-S2), Automatic setup, Satellite guide, Terrestrial signal (DVB-T) setup.

Language and Menu setup, EDIVISION and Teletext, Subtitles, Parental Control/Program safety, Receiver Lock, Password, Clock setup, Time, Time Zone, Summer Time adjustment, Date, Timer control, Audio & Video setup (display function, visual angle, Video output control, Digital Audio control)

Software info, Factory default values, USB/HDD update, external USB/HDD backup (software, channel lists)

Tetris, Snake, Othello

Network setup (Wired/WiFi, DHCP, IP address, Subnet Mask, Port, DNS), HTTP update (manual, auto), FTP, weather forecast, RSS news.

Smart Card

File lists (recording, MP3, JPG images, software), memory info (format HDD, DVR setup), PVR setup, USB/HDD Speed Test, Safely Remove USB device.

* Active only when a compatible external USB memory device is plugged in.

By pressing the «INFO» button during the TV/Radio mode, the info window appears. If available, information on TV/Radio, program recording storage option, currently displayed channel, program & favorites list, current & next program, will appear in this window.

- TTX eteletext (optional)
- EPG EDIVISION (optional)
- Program scrambled
- Subtitle (optional)
- Program locked
- Channel in Favorites list

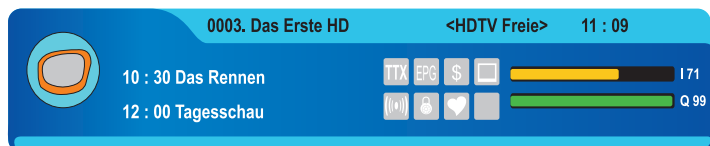

OPTIMUSS underline 3in1

High Definition Combo Receiver

Front panel

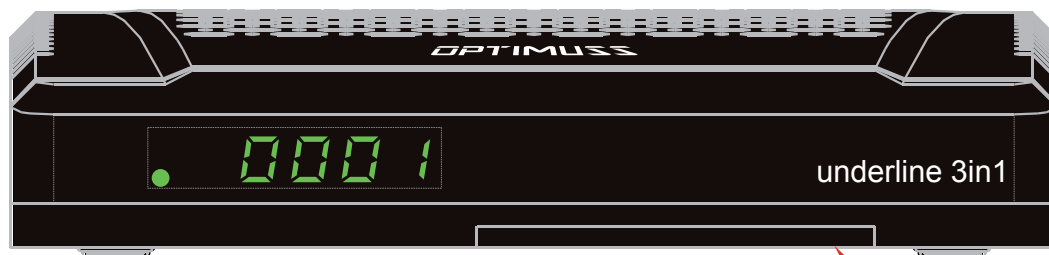

- ① Embedded card reader
- ② USB 2.0 port: for connecting external USB storage devices
- ③ Holder for installation on a vertical surface
(It has stickers on the rear side support / stabilization)

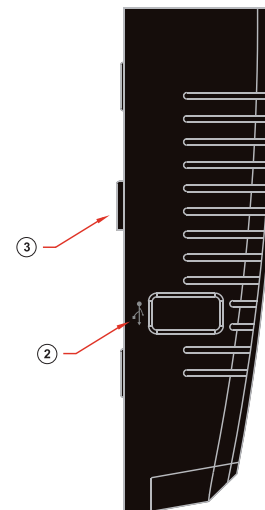

Remote Control

Note: Some buttons refer to optional functions or have more functions, as appear in the respective menus

POWER

- ON/OFF button
- Sound ON/OFF
- Number & letter character use in the Menus, selection of TV/radio programs
- TV/RADIO function selection
- «0» number selection, zoom function
- Last program recall
- Menu Button Audio
- Program Info window display
- TV/STB**
- TV/AV picture choice (not valid during use of HDMI)

MENU

- Main Menu display
- EPG**
- EDIVISION program display
- EXIT**
- Closes a menu/dialog window



Using the arrow buttons you can move in the lists or change the volume level. With «OK» you confirm your choice in the menu or display the program list

- List page scroll (back)
- List page scroll (forward)
- Goes to AUDIO menu
- Multiple option button, for channels where available
- Moves to Subtitle/Videotext menu
- Moves to multiple image function (optional)
- Off button
- FIND**
- Program search in list
- Auto StandBy mode Timer
- Safely remove USB device
- Displays a file list

- SAT**
- Satellite list display
- FAV**
- Favorites list display (if configured)
- Time Shift display
- Playback start for Time Shift function and from a recorded file.
- Time Shift function stop, in record or playback
- Playback stop
- Manual record
- Jump to the beginning or the previous recording / image.
- Go to the end or the next record / image.
- Slow playback backwards (1/2-1/8) from a recorded file
- Slow playback forward (1/2-1/8) from a recorded file



Rear side

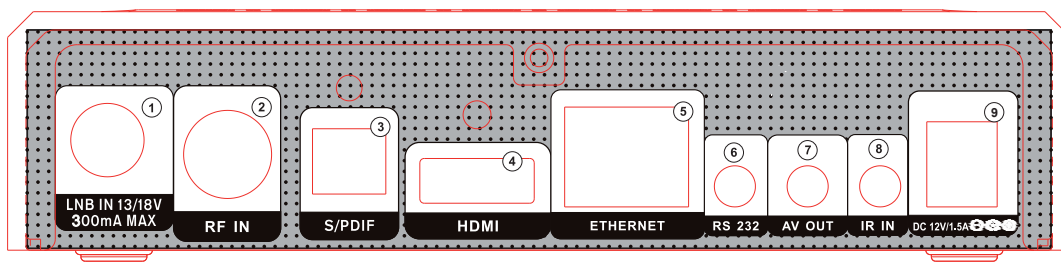

- ① LNB IN: for connecting the coaxial cable from the LNB, using the proper plug
- ② RF IN: Connect to coaxial cable or terrestrial signal cable
- ③ S/PDIF: Audio interface for amplifier/audio console
- ④ HDMI: for connection to a TV set, using HDMI cable. For HD TV signals
- ⑤ ETHERNET (RJ45): for connection with LAN/INTERNET, for home use
- ⑥ RS 232: for connecting to a PC, using RS-232 cable, for receiver software update
- ⑦ AV OUT: For broadcasting video and sound signals
- ⑧ IR IN: Infrared connection port
- ⑨ Connect the receiver to the power supply via its PSU 12V/1.5A

For further information, please visit our website:
www.edision.gr